

V-0930P

영구 고정식 사용 지침

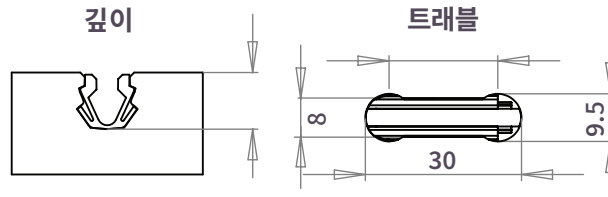

1. 밀링

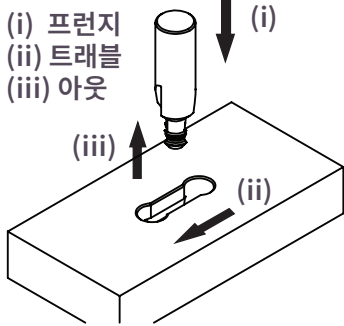

권장 간격
(a): 35mm에서 80mm 까지
(b): 150mm에서 350mm까지

조립구간

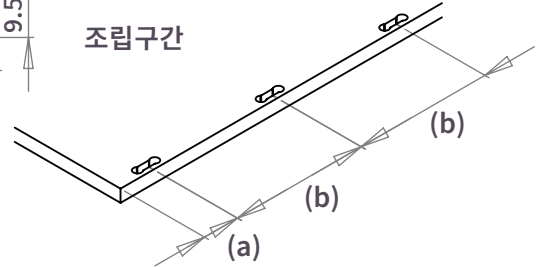

권장 설정

깊이: 9.4mm, +/- 0.1mm

트래블 중심간 이동: 20.5mm

회전 속도: CNC 속도는 재료에 따라 다릅니다.

최대 커터 회전 속도: 18,000

2. 하우징

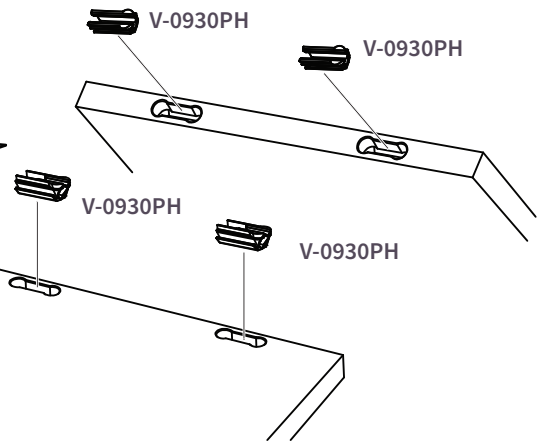
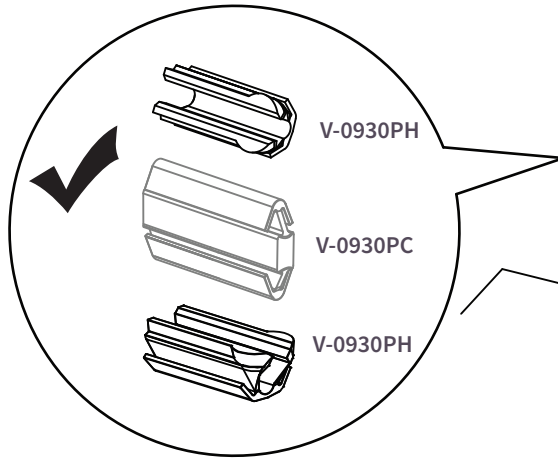

3. 조립 - 간단하게 눌러서 연결

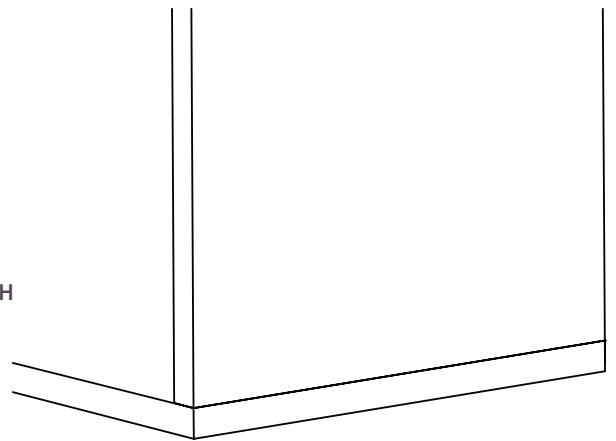
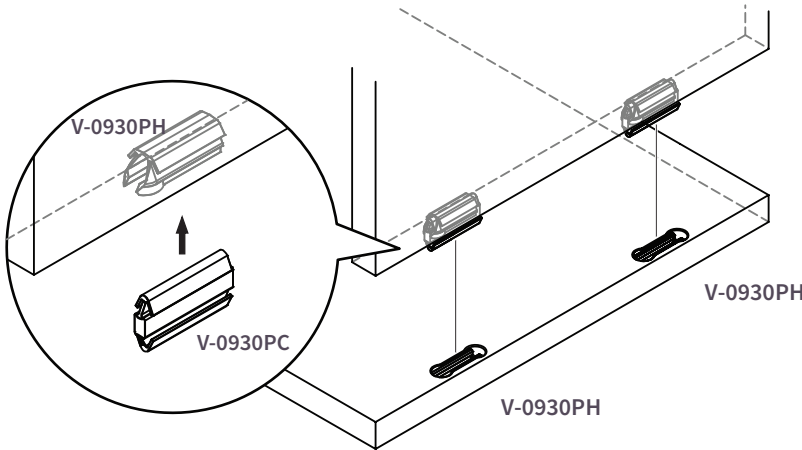

작동 방식

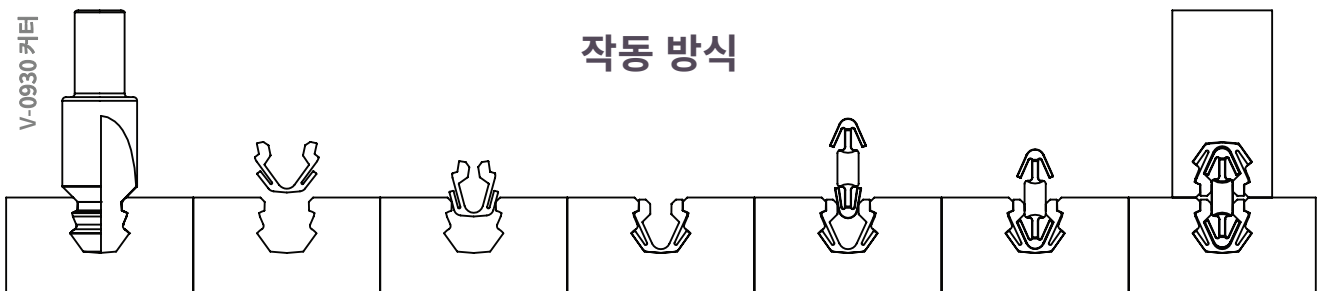

OVVO® V Connection System



중요! 테스트를 진행하세요.



중요! 테스트를 진행하세요.
IMPORTANT! MAKE A TEST
WICHTIG! MACHEN SIE EINEN TEST
IMPORTANT! FAIRE UN TEST
IMPORTANTE! FARE UN TEST
IMPORTANTE! HACER UNA PRUEBA

권장하는 깊이 허용 범위

V-0930

9.4mm, +/- 0.1mm

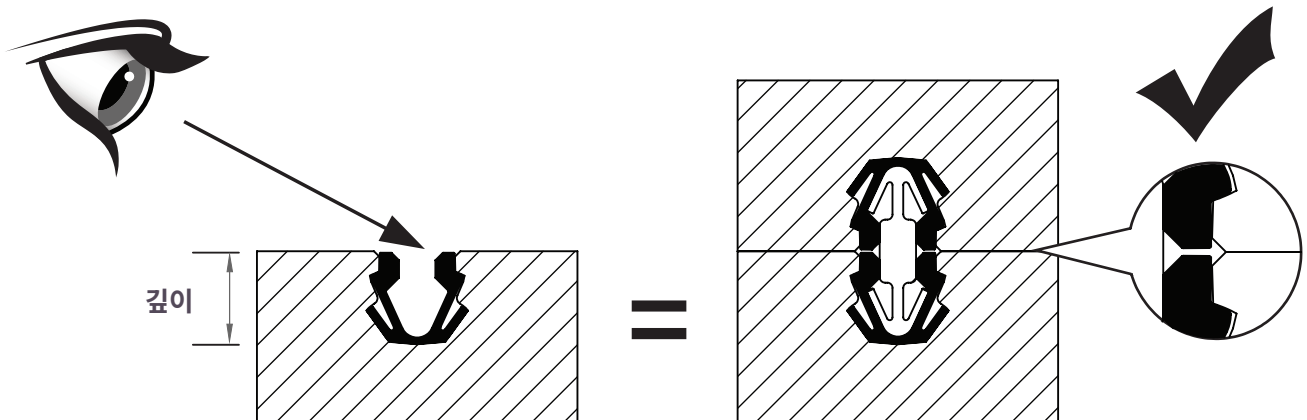
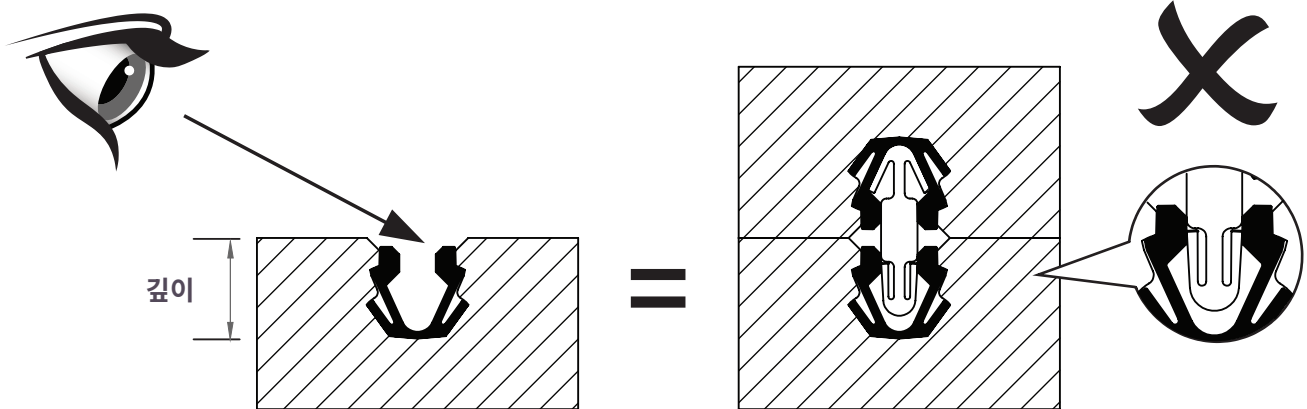
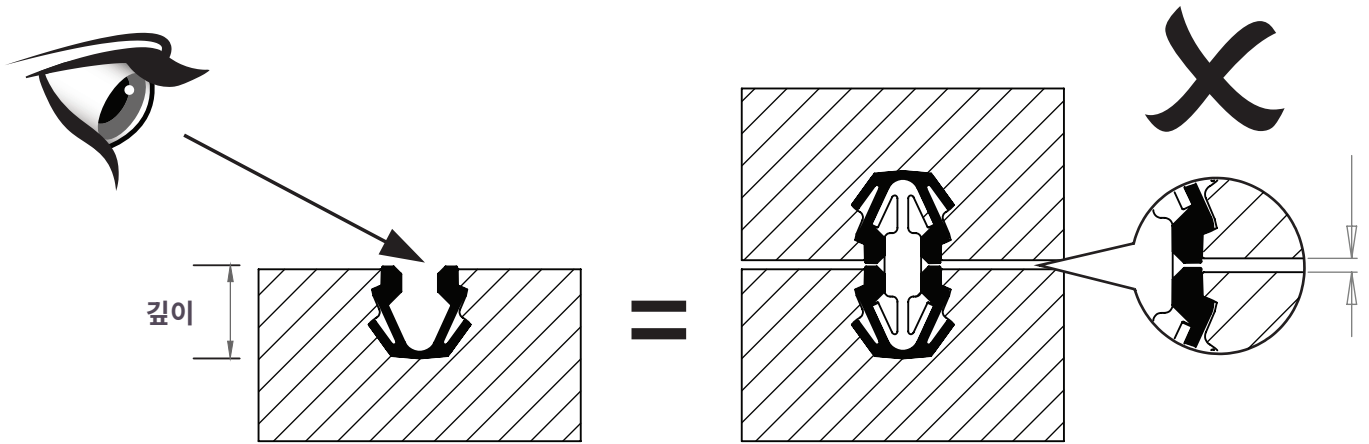

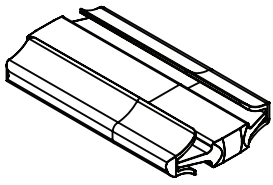

V-0930PC 사용 지침



1. 커넥터 V-0930

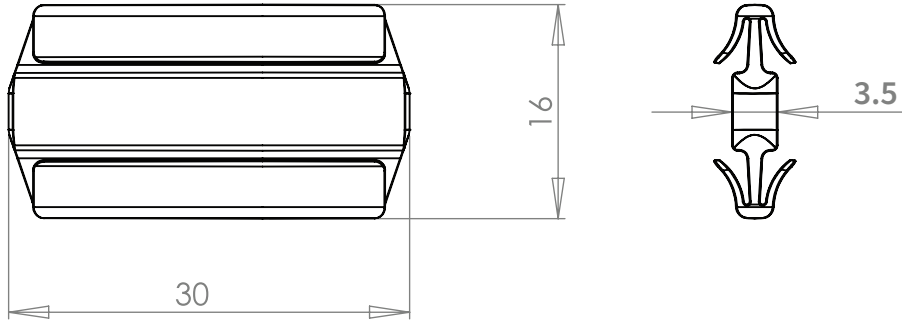

2. 밀링 예시

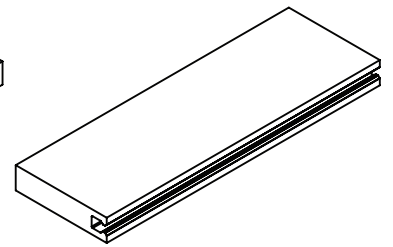
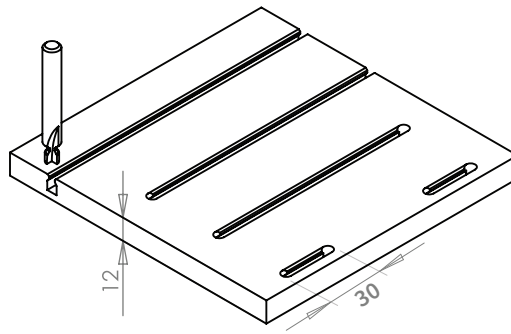
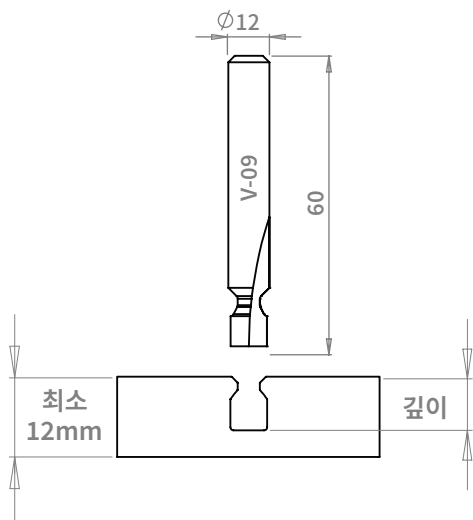

권장 설정

깊이: 9.3mm +/- 0.1mm

회전: 속도는 재료에 따라 다릅니다.

권장 간격: 100mm / 300 mm

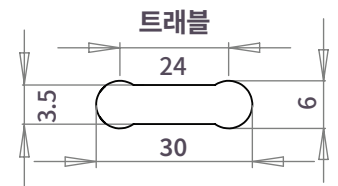

3. 조립

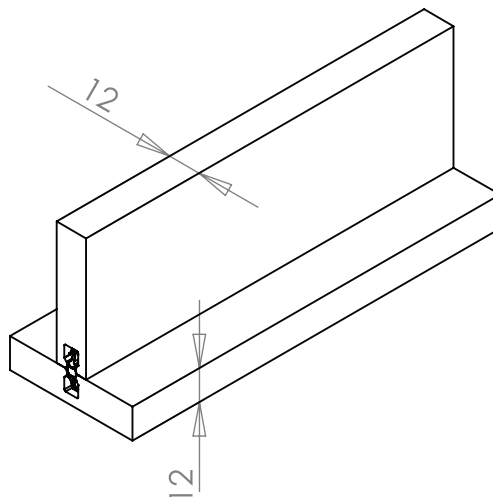
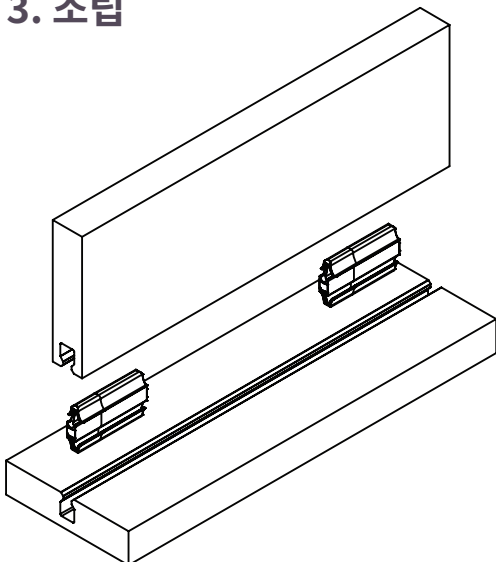

접착제와 함께
사용할 수 있습니다.